

**Heathfield Drive
Mitcham, CR4 3RH**

£250,000 Leasehold

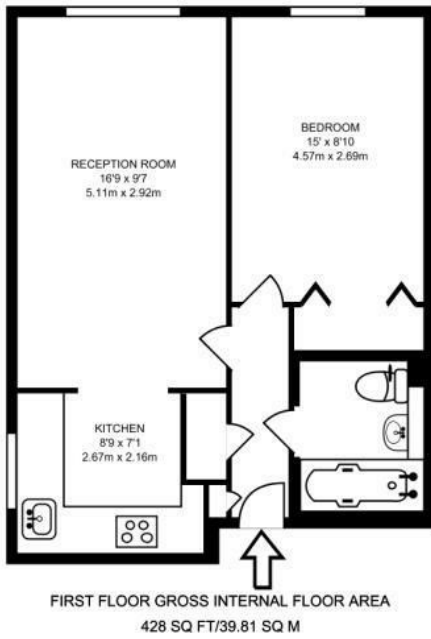

Ellisons are pleased to bring to the market this one bedroom first floor flat, that comes with its own allocated parking space. Located close to Colliers Wood Tube Station, the property has an open plan living area with fitted kitchen and views over Lavender Park, double bedroom with plenty of storage and family bathroom. Ideal purchase for first time buyers looking to get onto the London property ladder. A must view property! Book now to arrange your viewing.



- One Double Bedroom
- Views Across Lavender Park
- Ideal First Time Purchase
- Allocated Parking
- First Floor
- Sought After Location
- EPC Rating : C

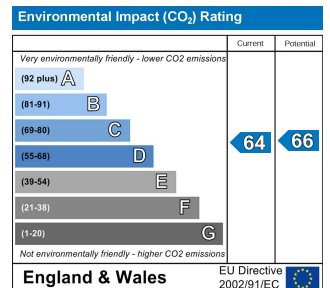
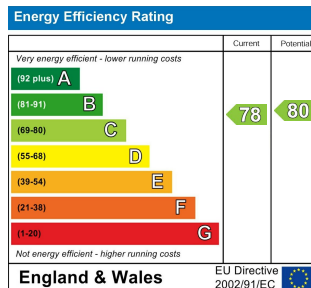

For Free Mortgage Quote and Best Mortgage Rates, call an Ellisons Mortgage Advisor on 020 8544 0518



Although these particulars are believed to be correct, their accuracy is not guaranteed and they do not form part of any contract.

Celebrating 30 years of successful Sales and Lettings in Merton

